

D1

NO-DRILL LIGHT MOUNTS

DENOMINATOR DESIGNS



FOR LATE MODEL TRUCKS: 2020+

INSTALLATION MANUAL

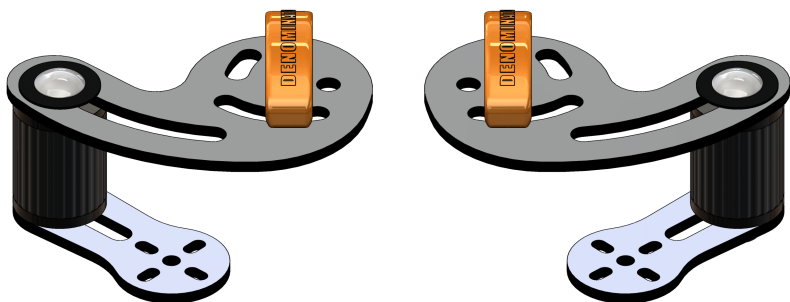

D1 A

FORD F-150

D1 B

**FORD SUPER DUTY
F-250, F-350, F-450**

D1 C

CHEVY SILVERADO 1500

D1 D

**DODGE RAM 1500, 2500, 3500
CHEVY SILVERADO 2500HD, 3500HD**



340 Atwood Lake Rd.
Cold Brook, NY 13324

(845) 764-8129

www.denominatordesigns.com

Thank you for purchasing a Denominator No-Drill Light Mount set!

This product enables rapid, noninvasive installation of a Light Bar onto the front Tow Hooks of late-model American Pickup Trucks (2020+).

WARNING

- Thoroughly read and understand the information in this manual before using or installing this product. Follow all installation instructions.
- Do not use product for any purpose other than its intended use.
- Tighten all fasteners securely following the instructions.
- Do not use as a means of towing.
- Do not use as a lifting point.
- Do not use as a step.

IN THE BOX:

- 2 x Denominator Tow-Hook Mounts
(Only 1 shown)

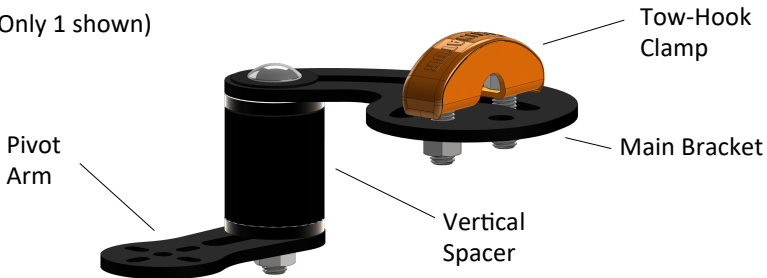

- 4 x 5/16-18 Nuts & Bolts
(For securing Pivot Arms to Light Bar Brackets.)
- Wooden Spacer (to position Light Bar while tightening).
- Installation Manual
- Warranty Card: **Scan Code on card (or mail in) to activate Warranty.**

TOOLS NEEDED:

- 2 x 1/2" Wrenches
 - 1 x 3/4" Wrench
- Ratcheting Wrenches work well.**



1/2



1/2



3/4

TRUCK SPECIFIC CLAMPS:

There are four different clamp styles on Denominator Mounts matching the different tow-hook profiles on late model trucks.

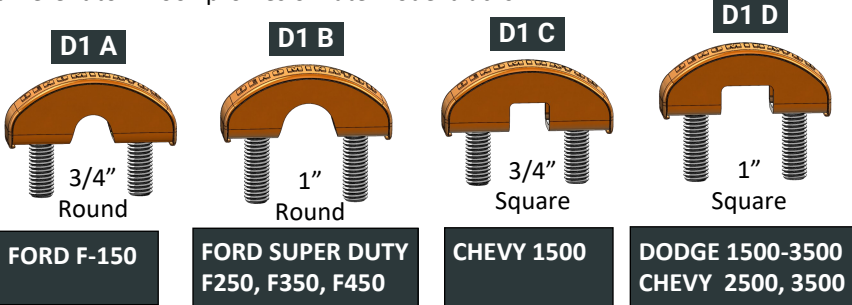

Clamps can be positioned at various points on the tow-hook to optimize bracket placement for different vehicles.

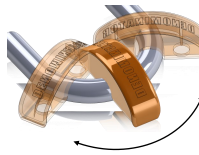

VERTICAL SPACER:

The vertical spacer column can go either up (A) or down (B) to avoid license plate, cameras and sensors. To change:

1. Loosen the nut (D) and remove bolt (C).
2. Reposition the pivot arm and spacers on the other side of the main bracket.
3. Insert bolt and re-tighten nut in the new position (head of bolt should always be up).

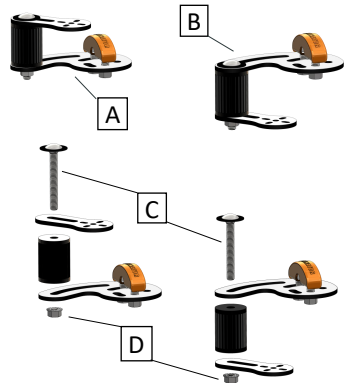

MAIN BRACKET POSITIONING:

The main brackets can be positioned in multiple ways to accommodate a large variety of trucks and light bar sizes:

- Facing in or out
- Facing back or forwards



Main Brackets facing in and back

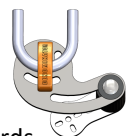

Main Brackets facing out and forwards

See pages 4 and 5 for positioning guidelines

POSITIONING GUIDELINES

Install light bar where it does not block cameras, sensors or license plate.
For bigger trucks it typically works best to have the vertical spacer going up.
Adjust as appropriate for your specific model of vehicle and light bar size.

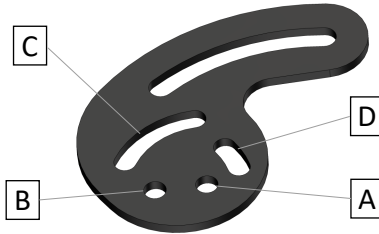
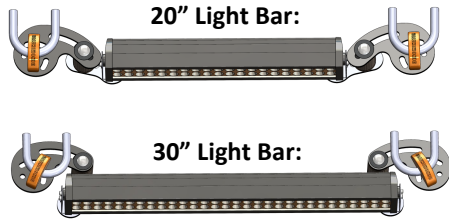
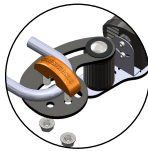

Figure 1: Main Bracket

Ford: F-150

Fasten clamp through **hole A** and **slot C** in main bracket (Fig. 1)



Ford Super Duty: F-250, F-350, F-450

All light bars:
Fasten clamp through **hole A** and **slot C** in main bracket (Fig.1)

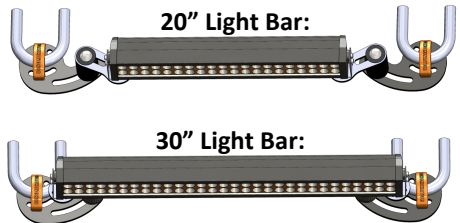

40" Light Bar
Clamp &
Bracket

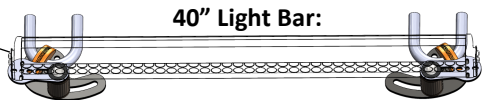

50" Light Bar
Clamp &
Bracket

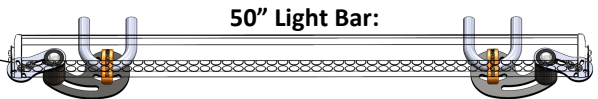

Dodge Ram: 1500, 2500, 3500

20" bar: Bolts go through **hole B** and **slot C** in main bracket (Fig. 1)



20" Light Bar:



30" Light Bar:

30" - 50" bars: Bolts go through **hole A** and **slot C** (Fig. 1)

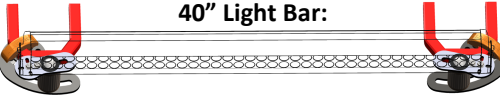
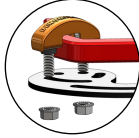

40" Light Bar:

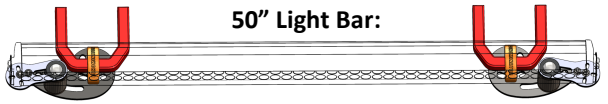

50" Light Bar:

Chevrolet Silverado: 1500

Clamp Bolts go through **hole A** and **slot C** in main bracket (Fig. 1)

20" Bar shown in down position.
30" Bar works best going up (as shown).

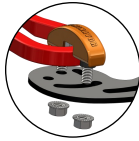

20" Light Bar:

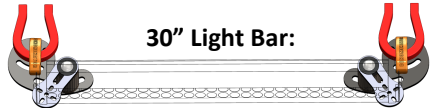

30" Light Bar:

Chevrolet Silverado: 2500HD, 3500HD

All light bars: Fasten clamp through **hole A** and **slot C** in main bracket (Fig. 1)

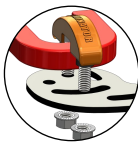

20" Light Bar:

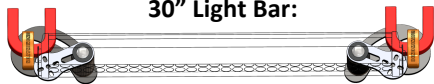

30" Light Bar:

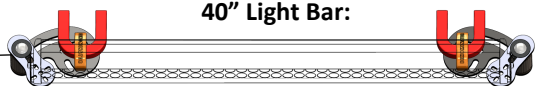
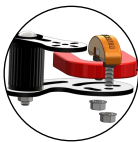

40" Light Bar:

INSTALLATION INSTRUCTIONS

1

Remove nuts from Tow-Hook clamps, then place over Tow-Hook as shown.

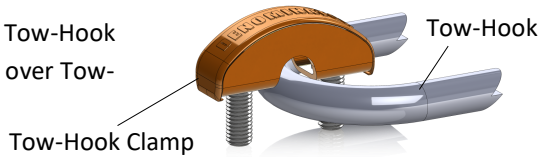

2

Slide Main Bracket up over bolts. Attach nuts and tighten snug, but not completely tight (Main Bracket should still be move-able).

Swing main bracket in so that Vertical Spacer is close to the Truck.

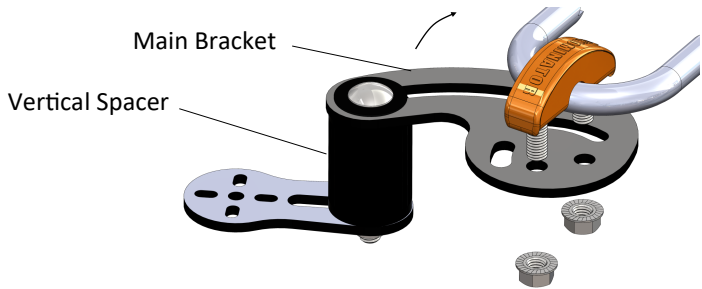

3

Determine if vertical spacer should go up or down and if necessary make the change by removing nut and repositioning above or below main bracket as needed (head of bolt should stay on top).

(See "Vertical Spacer" section on page 3.)

4

Rotate the pivot arms to approximately the right position to accommodate the light bar size (see pages 4 and 5).

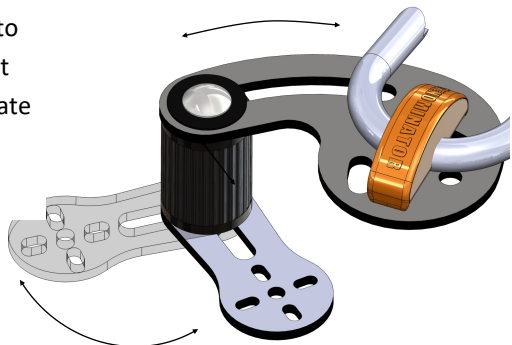

5

Place Light Bar on Pivot Arms and secure with bolts and nuts. If possible use 2 bolts at each end. Do not tighten yet.



If clearance is tight, thread bolts through from the bottom and place nuts on top as shown. Use the stainless bolts and nuts supplied.

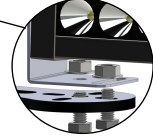

6

Make sure the light bar is centered on the truck and tucked in close to the front bumper.

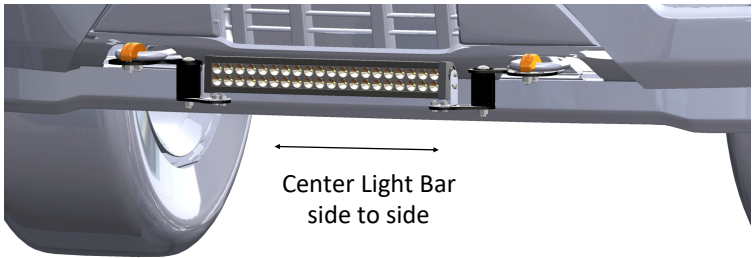

7

Tighten all the nuts to a snug-tight condition. Ensure all visible bolt heads and nuts are fully seated against their respective contact surfaces. Then apply final torque using full manual effort with a standard (or ratcheting) hand wrench. Tighten in the following order:

- 1 - Tow Hook Clamps (A)
- 2 - Light Bar Brackets (B)
- 3 - Vertical Columns (C)

Do not over-tighten.

When tightening the vertical spacers, the pivot arm will try to rotate in the same direction as the nut.

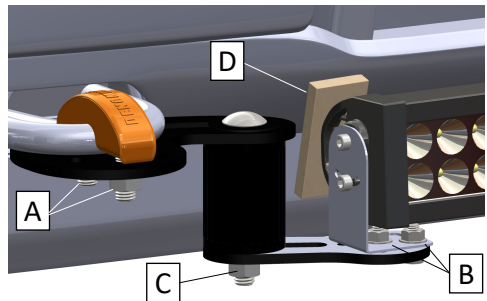

To prevent this, hold the end of the Light Bar firmly while tightening. For the side where the pivot arm is rotating in, place the wooden spacer (D) between the Light Bar and the truck to maintain proper alignment and positioning.

MAINTENANCE

- After 25 miles or first use, inspect the light bar mounts to ensure that all fasteners remain tight.
- Recheck at every vehicle oil change to maintain a secure installation.
- If the mounts are removed from the vehicle, apply thread locker to all bolts before re-installing. (We recommend Vibra-tite VC3 Threadmate.)

CUSTOMER SUPPORT



Information &
How-to Videos

Phone: (845) 764-8129

Email: sales@denominatordesigns.com

Website: www.denominatordesigns.com

