



Blade Quick Connect Harness Installation Instructions

Congratulations on your purchase of a high quality PUTCO product. Should you need any application or technical assistance, feel free to call us at: 1-800-247-3974

Monday-Friday 8:00 a.m. - 5:00 p.m. (Central Standard Time)

Contact your PUTCO dealer for other quality accessories.

Please read all instructions before installation and to check to see that all parts are included.

KIT CONTENTS:	
Description	Qty
Blade Quick Connect Harness	1

Blade Quick Connect Harness Installation

1. Unplug the factory 7 pin trailer connector from the truck, then plug it into the Blade Quick Connect Harness. Plug the other end of the Quick Connect Harness into the 7 pin plug on the bumper. Refer to Figure 1.

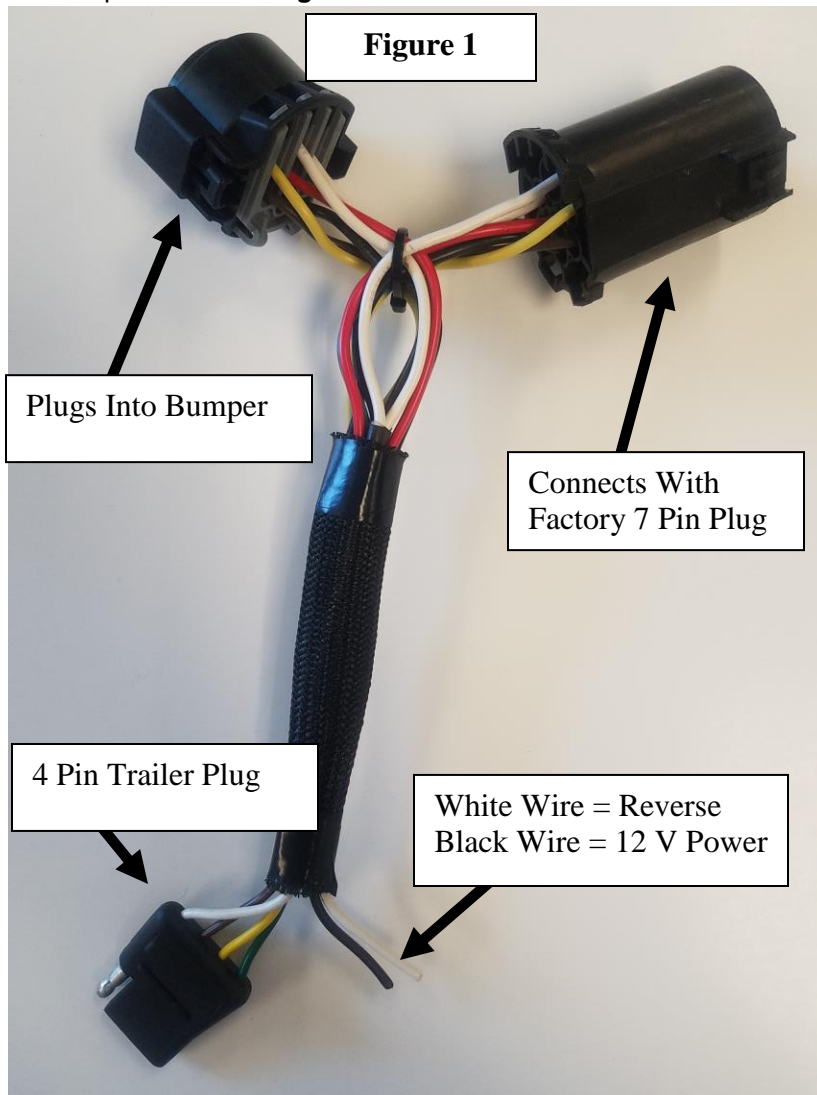



2. Connect the 4 Pin Trailer Plug to the Blade Tailgate Lightbar or other accessory.
3. Solder or use crimp terminals to connect the white (reverse) wire of the Blade Quick Connect Harness to the Blade Tailgate Lightbar's white (reverse) wire.
4. Solder or use crimp terminals to connect the black (power) wire of the Blade Quick Connect Harness to your Blade Tailgate Lightbar's red (power) wire.
5. If the reverse or power wire on the Blade Quick Connect Harness are not being used in your application, be sure to insulate the ends with heat shrink or electrical tape to prevent a short.

For other quality lights and lighting accessories, visit www.Putco.com